

KEY PLAN

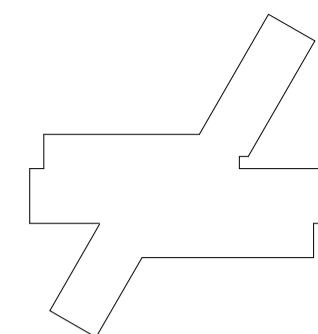

CDM

THE FOLLOWING INFORMATION IS TO BE REVIEWED IN CONJUNCTION WITH THE GDA, RESIDUAL RISK REGISTER FOR THE PROJECT AND THE NORMAL HAZARDS AND RISKS ASSOCIATED WITH THE WORK TO BE CARRIED OUT IN LINE WITH THE PROPOSALS

THE CONTRACTOR SHALL ENSURE THAT PRIOR TO COMMENCEMENT OF WORKS, ALL WORK SHALL HAVE IN PLACE A FULL METHOD STATEMENT & RISK ASSESSMENT. THE CONTRACTOR SHALL ALSO ENSURE THAT ALL OPERATIVES ARE CORRECTLY INDUCTED ARE COMPETENT TO UNDERTAKE THE WORK. ALL TEMPORARY WORKS REQUIRED TO UNDERTAKE THE WORKS SHALL BE DESIGNED BY THE CONTRACTOR. ANY SPECIAL CONSTRUCTION SEQUENCES ARE IDENTIFIED ON THE DRAWING WHERE REQUIRED.

CONSTRUCTION	ITEM
MAINTENANCE	ITEM
DECOMMISSIONING/DEMOLITION	ITEM

Department Legend

Art	Music
Main Hall	PE
Changing	Plant
Circulation	Reception
Design Technology	Science
Drama	Science Prep
General Teaching	SEN
ICT	Sixth Form
ICT Server	Staff Admin
Kitchen	Storage - Teaching
Learning Resources	Storage - Non-Teaching
	Toilets

G	21.11.11	JuD	JH	Issued for information
F	03.11.11	JuD	JH	Issued for information
E	31.10.11	JuD	JH	Issued for information
D	19.10.11	JuD	JH	Issued for information
C	07.10.11	JuD	JH	Issued for information
B	06.10.11	CH	JuD	Issued for draft planning set
A	27.09.11	SN	JuD	Issued for information
Rev	Date	By	Check	Note

DRAWING STATUS

CONTRACTOR'S PROPOSALS

CLIENT

SUFFOLK C. C. AND A.E.T

PRINCIPAL CONTRACTOR



DESIGN CONSULTANT

jestico + whites

1 Cobourg Street London NW1 2HP
 t +44 (0) 20 7380 0382 f +44 (0) 87 0622 0732 w jesticovhiles.com

architecture interior design london | prague

PROJECT

FELIXSTOWE ACADEMY

DRAWING TITLE

PROPOSED GROUND FLOOR PLAN

DATE	SCALE	AUTHOR	CHECKED
25/09/11	1 : 200	SN	HP
STATUS:			

DRAWING No.
01-001

REV.
G

