

RESPONSIBILITY IS NOT ACCEPTED FOR ERRORS MADE BY OTHERS SCALING DIRECTLY FROM THIS DRAWING. ALL CONSTRUCTION INFORMATION SHOULD BE TAKEN FROM NOTED AND DIMENSIONED FIGURES ONLY.

**A1** Original Sheet Size  
0mm 50mm

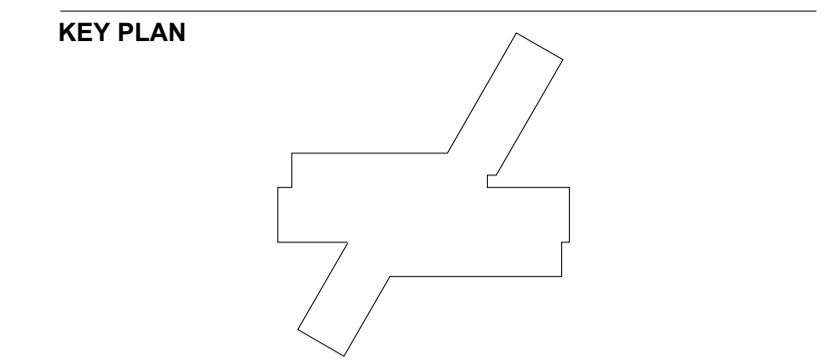

**CDM**  
THE FOLLOWING INFORMATION IS TO BE REVIEWED IN CONJUNCTION WITH THE GDA RESIDUAL RISK REGISTER FOR THE PROJECT AND THE NORMAL HAZARDS AND RISKS ASSOCIATED WITH THE WORK TO BE CARRIED OUT IN LINE WITH THE PROPOSALS.

THE CONTRACTOR SHALL ENSURE THAT PRIOR TO COMMENCEMENT OF WORKS, ALL WORK SHALL HAVE IN PLACE A FULL METHOD STATEMENT & RISK ASSESSMENT. THE CONTRACTOR SHALL ALSO ENSURE THAT ALL OPERATIVES ARE CORRECTLY INDUCTED AND ARE COMPETENT TO UNDERTAKE THE WORK. ALL TEMPORARY WORKS REQUIRED TO UNDERTAKE THE WORKS SHALL BE DESIGNED BY THE CONTRACTOR. ANY SPECIAL CONSTRUCTION SEQUENCES ARE IDENTIFIED ON THE DRAWING WHERE REQUIRED.

CONSTRUCTION	ITEM
MAINTENANCE	ITEM
DECOMMISSIONING/DEMOLITION	ITEM

- SOFTWORKS**
- Grass - Seed
  - Grass - Wildflower
  - Grass - Meadow
  - Ornamental shrub planting
  - Hedge
  - Trees
  - Existing trees / vegetation to be retained and protected

- KEY**
- HARDWORKS**
- Tarmacadam surface
  - Coloured block paver to pedestrian crossings (tbc)
  - Hard surface Type / finish to be confirmed
  - Existing surface treatment to be retained
  - Plastic modular reinforced grass system with grass infill
  - Existing timber access ramp and steps to fitness suite
  - Hoggin or similar approved aggregate
  - Synthetic grass (Existing)
  - Multi Use Games Area (MUGA)
  - Existing Public Right of Way (PRoW)
  - Seating
  - Potential Canopy (Existing from Deben High School)
  - Sheffield Cycle Stands (uncovered)
  - Accessible parking bay sign/bollard
  - Potential Outdoor Lockers

- FENCING**
- 2.4m Proposed Weldmesh Fence
  - 1.8m Proposed Weldmesh Fence
  - 3m Proposed Weldmesh Court Fence
  - 2m Proposed Timber Closeboard Fence
  - 1.8m Proposed Timber Closeboard Fence
  - 1.1m Proposed Timber Post & Rail Fence
  - 0.4m Proposed Timber Knee Rail
  - Vehicle Barrier
  - 1.5m Existing Metal Railings
  - 1.5m Existing Plastic Coated Chain Link Fence (Timber/Metal Post)
  - 1.8m Existing Metal Panel Fence
  - 2m Existing Brick Wall
  - 3m Existing Chain Link Fence (Concrete/Metal Post)
  - 2.4m Existing Chain Link Fence (Concrete/Metal Post)
  - 1.8m Existing Closeboard Timber Fencing
  - 1.5m Existing Closeboard Timber Fencing
  - 3m Existing Weldmesh Court Fence

Rev	Date	By	Check	Note

DRAWING STATUS: **PLANNING**  
 CLIENT: **SUFFOLK COUNTY COUNCIL AND A.E.T**  
 PRINCIPAL CONTRACTOR: **Balfour Beatty**  
 ZERO HARM BY 2012

DESIGN CONSULTANT: **oobe**  
 landscape architecture | urban design | masterplanning

PROJECT: **FELIXSTOWE ACADEMY**

DRAWING TITLE: **SITE PLAN OVERVIEW**

DATE	SCALE	AUTHOR	CHECKED
Oct 2011	1:1000@A1	RC	KM
STATUS: <b>FINAL</b>			
DRAWING No:	FEL-OBE-90-002		REV: -



FOR DETAILED INFORMATION IN RELATION TO THE ACCESS ROAD REFER TO DRAWING SUBMITTED FOR DISCHARGE OF CONDITION 77 IN REFERENCE TO PLANNING APPLICATION CO/0161

LOCATION OF PROPOSED FENCE BENEATH TREES INDICATIVE ONLY - TO BE CONFIRMED ON SITE

